

# NORTH GALLERY ROOMS 4, 5, 6 & 7

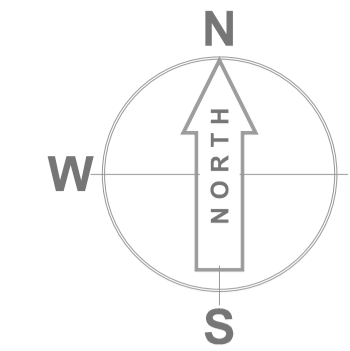

## The Gallery Rooms (Level 2)

- Dimmable house lighting
- All suite are acoustically sealed
- All rooms have sun blinds
- Audio visual equipment available on request

## Ceiling height

- Maximum headroom 3.25m clear to ceiling

## Door dimensions

- Maximum headroom: 2m clear to door head
- Door width: 1.5m

## Maximum loading

- Breakout areas: 5.0kn/m<sup>2</sup>

## Lift dimensions mm

- Door Clearance 2090 h x 1100 w
- Car Interior 2400 h x 1860 w x 1550 d
- Weight loading: 16 persons / 1350 kg

- 1 Floor box type 1  
2 x 13 AMP Sockets  
4 x jack plugs
- 2 Floor box type 2  
2 x 13 AMP Sockets  
1 x 15 PIN Female PC socket  
1 x video jack  
1 x Switched Spur  
1 x Blank Plate

- 3 Floor box type 4  
2 x 13 AMP Sockets

- Blanking plate

- Ceiling Projection Mounting Point  
Available on request

- A 16 AMP three phase supply in adaptable box under floor  
(Below raised Floor) Available on request

- B 63 AMP three phase supply in adaptable box under floor  
(Below raised Floor) Available on request

- Floor access grommet

- E \* Fire Exit to be kept clear at all times

- TOILETS

- KITCHEN

- CLOAKROOM

- NOT FOR PUBLIC USE

- PUBLIC LIFT

- GOODS LIFT

- Movable wall partition

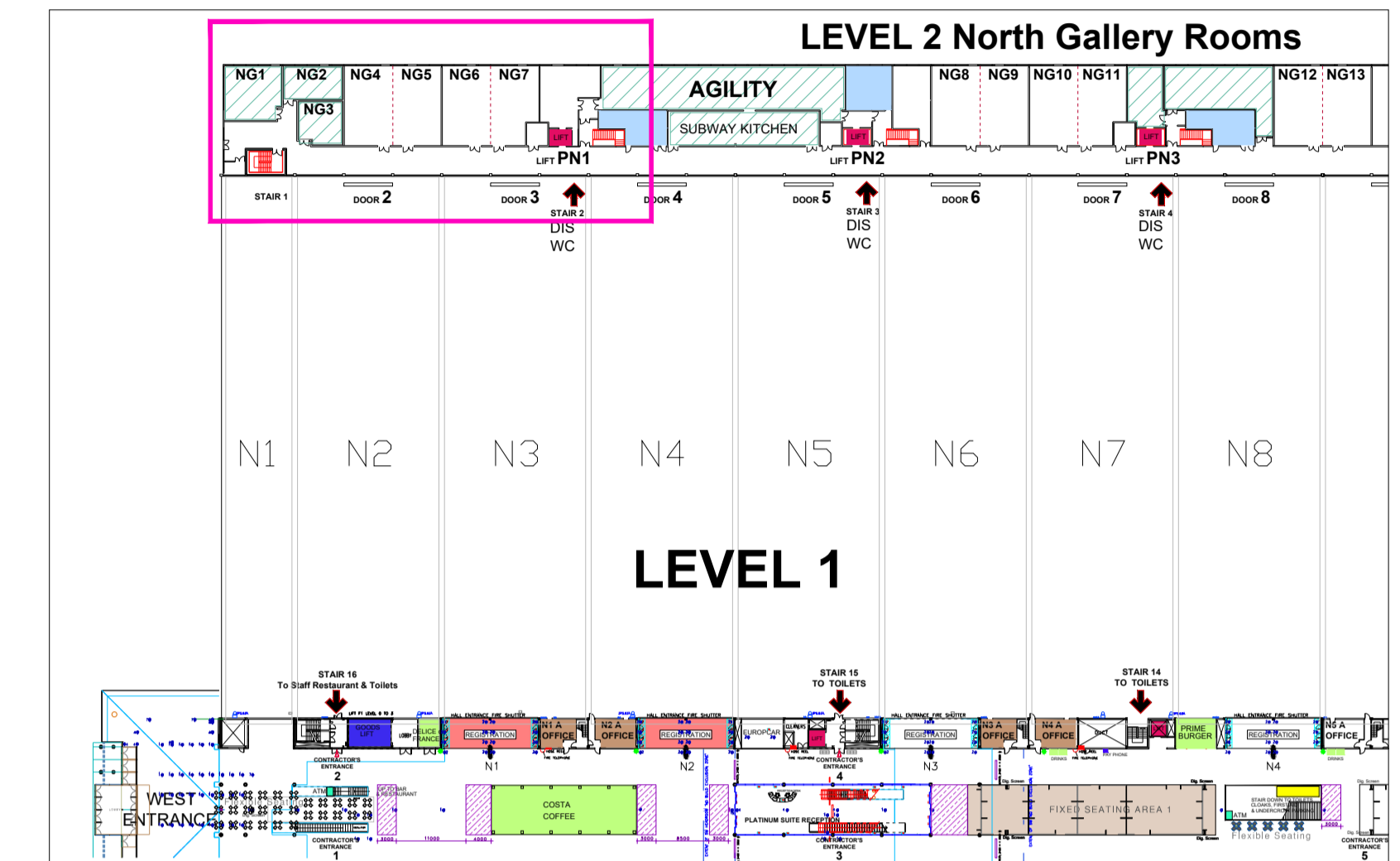

LOCATION PLAN SCALE 1:1000

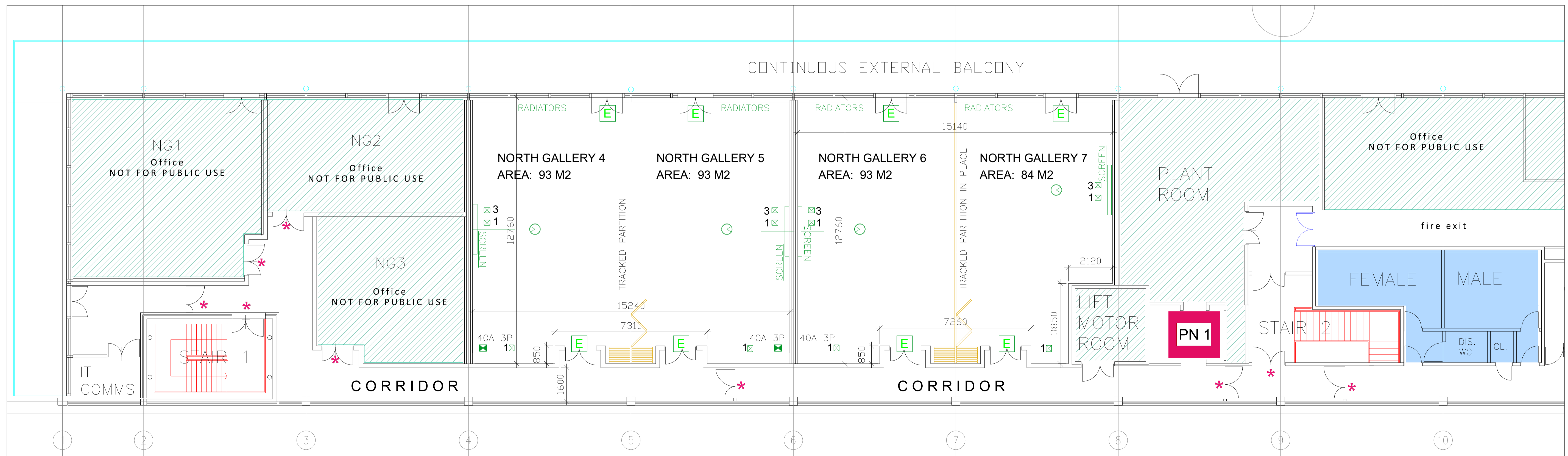

NORTH GALLERY 4 & 5  
AREA: 186 M2

NORTH GALLERY 6 & 7  
AREA: 177 M2

